

C-87-195

Paul Hammerly

C-159-86

Peter Pecker

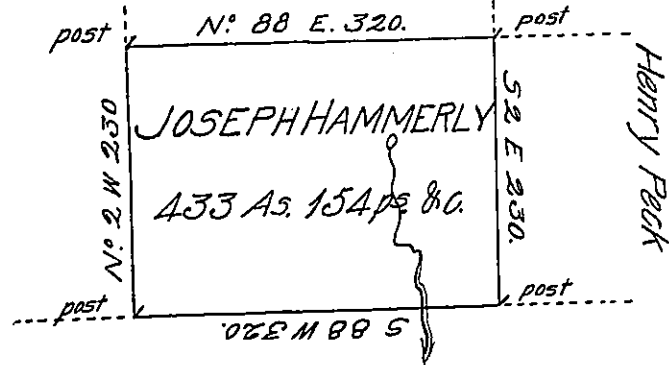

C-159-87

Henry Reeder

C-170-187

In pursuance of a Warrant dated February 18<sup>th</sup> 1793. Surveyed Sept<sup>r</sup> 15<sup>th</sup> 1794. by  
 Anth<sup>y</sup> Crothers late Dept<sup>y</sup> Surveyor for Joseph Hammerly the above discribed tract  
 of Land situate on the Waters of Wysauken Creek in the County of Luzerne containing  
 Four hundred and thirty three Acres and one hundred and fifty four perches and  
 the Allowance of Six per Cent. Ex<sup>d</sup> & Certified by me this 16<sup>th</sup> Feb<sup>y</sup> 1803.

Tho<sup>s</sup> Sambourn D<sup>y</sup> S<sup>r</sup>

Samuel Cochran Esq<sup>r</sup>

Surveyor Gen<sup>l</sup>

IN TESTIMONY that the above is a copy of the original remaining on file in  
 the Department of Internal Affairs of Pennsylvania, made  
 conformably to an Act of Assembly approved the 16th day of  
 February, 1833, I have hereunto set my Hand and caused  
 the Seal of said Department to be affixed at Harrisburg,  
 this twentyfourth day of April 1905.

*James R. Brown*  
 Secretary of Internal Affairs.